



Wingspan Life Resources
30 East Plato Boulevard
St. Paul, MN 55107

RETURN SERVICE REQUESTED

Celebrate our 51st Year!

Power of Love Gala
Metropolitan Ballroom
Tuesday Evening, May 21st

Our Mission!

To inspire community by empowering
people impacted by disabilities
to live their best life.

NON PROFIT ORG
US POSTAGE
PAID
PERMIT 991
TWIN CITIES MN

2022-2023 ANNUAL REPORT



A PLACE TO CALL HOME!

Celebrating our **50th** Year of Service



wingspanlife.org

Dear Friends,

As I mentioned at our Power of Love celebration in May, I've been at Wingspan for most of our 50 years and I've never lost sight of our incredibly rich history because it is so strongly linked to who we are today. Service trends, buildings, people come and go, but we still stand firmly with the vision we created back in the 70s because, at its core, it was **so right and so strong** that it is still relevant and always in line with whatever passing trends come and go.

We've grown so much from our days as a 30-bed care facility for women at St. Ann's. We're in the process of purchasing our 31st group home, and expanding our service to include crisis services for children with developmental disabilities. I'm grateful for the leadership provided by our Board and management teams. Thoughtful collaboration has been key.

We've been fortunate over the years to have many people who, like me, learned how to serve, how to provide opportunities for our clients to live their best life, directly from those we serve. So much has changed since I joined Wingspan 46 years ago, but the one thing that hasn't changed is our philosophy of service and our deep commitment to our core values – fellowship, growth, integrity, learning, and respect. People still often comment “there's just something so different and unique about a Wingspan home.”



Board Chair, Angela O'Neill and Executive Director, Therese Davis.

“Everybody can be great...because everybody can serve. You don't have to have a college degree to serve. You don't have to make your subject and verb agree to serve. You only need a heart full of grace. A soul generated by love.”

Martin Luther King

I have worked alongside so many who have put their heart and soul into service. My own service to Wingspan is grounded in deep gratitude for the privilege of having cared for and loved so many people, and for having been so loved by them.

You'll find plenty of examples of that grace and love inside our Wingspan homes and inside our Plato campus. The highlight of my week is any opportunity to engage with those we serve, whether it's a birthday celebration, a holiday party, or one of our enrichment programs such as Glee Club or our recent dance and theater classes.



Therese & Gracie

As the season of giving approaches, thank you so much for reaching into your heart to give generously. It means the world to us and to those we serve.

From our very big Wingspan family to yours, we wish you a happy, healthy holiday season.

Therese Davis, Executive Director

2022-23 BOARD OF DIRECTORS

Chair – Angela O'Neill
Associated Bank

Vice Chair – Joe Eickhoff*

Treasurer – Roz Allyson, CPA
Mahoney CPAs and Advisors

Chair Emeritus – John Thames,
Retired

Mary Anderson, Viking Electric
LeRoy Bergerson,* Retired

Preston Koenig, Wealth Enhancement Group

Taree Leach-Junkersfeld,* Retired

Mark Mooney,* Edina Realty

Bruce Smith,* Retired

Kim Wolff, Department of Veterans Affairs

*A family member is being served or has been served by Wingspan.

Did You Know?

45

People Celebrated
10+ Years
of Service

13

People Celebrated
20+ Years
of Service

7

People Celebrated
30+ Years
of Service

2

People Celebrated
40+ Years
of Service



Gifts of Time & Talent

238 Volunteers donated over 916 hours

Our In-Home Programs



**In-Home
Clients Served**

35



**Employment
Assistance Services**

4

Keeping Our Homes and Transportation Safe and Well Maintained



Appliances Purchased

4 Refrigerators
3 Dishwashers
3 Ovens
4 Washers
2 Dryers

Computers – \$7,740

Plus

A lot of furniture,
Household goods,
Driveway repair
And more



Used Vehicles Purchased

2016 Honda Odyssey \$23,700

The List Goes On...

Air Conditioner – \$5,420
Circulating Pump for Boiler – \$1,641
Hot Water Heater – \$2,219
AC Condenser – \$2,100
Carrier Condenser, Coil – \$5,400
Flooring – \$1,438
Kitchen Cupboards – \$8,930
Bathroom Remodel – \$2,320
Patio Set – \$2,000
Tree Removal – \$5,800

**Number of Clients
Who Went to
Camp Confidence**

13

**Number of Clients Who
Participated in Art &
Music Enrichment Programs**

45

In Loving Memory

Forever in our Hearts! Wingspan remembers these beloved members of our community who died during the past year.



*Gerald Wimmer
York House*



*Joseph Petersen
Our House Portland*

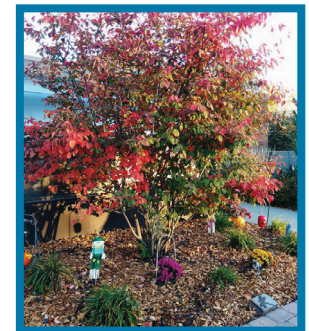

Wingspan's Legacy Garden

Wingspan has a legacy garden at our Plato campus where bricks engraved with names of all clients that have passed away over our 50 years have been placed. Since it's installation in 2016, Wingspan's memorial garden has provided a thoughtful place for remembrance and reflection—a place to hold dear the memories of those we have been privileged to call family. There are also bricks in memory of other loved ones and of beloved pets. Bricks are available for just \$100.

LEADERSHIP TEAM

Therese Davis, Executive Director

Joe Bjelland
Finance Director

Stacy Boehmer
*Director of
Residential Services*

Torrie Boehmer
Program Director

Pam Carlson
Operations Director

Darolyn Gray
Development Officer

Jeff Hager
Program Director

Eric Hemme
Program Director

Deb Hofbauer
Program Director

Crystal Jackson
Program Director

Stacy Jacobsen
RN, Registered Nurse

Julie Leiferman
Program Director

Deb Monk
*Human Resources
Director*

Shelda Thompson
Program Director

Camille Willner
*Director of
Specialized Services*

Rachel Zaffke
Program Director

Wingspan's CORE VALUES

CHOICE

GROWTH

RESPECT

INTEGRITY

LEARNING

FELLOWSHIP

There's a seat at our table.



Join Our Board of Directors!



Contact Therese Davis, Executive Director
tdavis@wingspanlife.org

The Porch Light is on at Aurora House

Aurora House is home to the “Aurora Stars,” clients Anita, Lisa, John, Julie and Sherri, who is currently in a transitional care facility and deeply missed by her housemates. Clients really care about each other and their staff. If someone is having a difficult day, each is ready to provide kind words of support.

“We really are like one big family,” says House Coordinator Alicia Wren. We are always up for an adventure out in the community and we love traveling around the metro, taking day trips to the St. Croix area or to Wisconsin. We decide as a group what would be of most interest, and off we go. We also celebrate holidays like a family. Before they go off for holiday celebrations with their families, it’s important that we have a Thanksgiving meal together and that we have a Christmas celebration together. The Aurora Stars have always loved being Secret Santas. They get very excited about picking names and shopping for just the right gift.”

Alicia and her Director Support Staff find many things to appreciate about each member of this Wingspan family.

Anita loves trying new things and never seems to get the “jitters” about new experiences. Alicia says, “She is happy-go-lucky and also has a lot of energy. She enjoys bowling, golf, and square dancing.



Table talk! John, HC Alicia Wren, PD Crystal Jackson, and Julie.



She also enjoys long hikes at the North Shore, especially in summer or when the leaves are changing. Anita is also very helpful around the house, always willing to pitch in.”

Lisa loves German shepherds, especially police dogs. She has a great sense of style and loves jewelry. On shopping trips, she likes to head right to the jewelry department to pick out a new accessory. She also has a great talent for remembering names. Alicia says, “Lisa is amazing. She even knows the names of the children of our staff, even the grandkids’ names. She’s very thoughtful.”

John has a very outgoing personality and enjoys meeting new people. He loves to sing and often carries his special microphone around the house to be ready to burst into song at any moment. He also has a good memory. Every year, Wingspan staff look forward to an opportunity for John to recite “The Night Before Christmas” by heart. He is quite the entertainer. Alicia says, “John’s great memory makes him our perfect navigator. He seems to always know the directions to anyplace we are going, including every turn. John is a big help outside which is wonderful because our property is so big. He loves to sweep and to rake—which keeps him very busy in the Fall.

Julie is described as “outdoorsy.” She loves being out in nature, whether it’s sitting out to enjoy the sun, walking in the neighborhood, or going on a hike. Any excuse to be out in the fresh air! Like Lisa, Julie loves to go shopping. Alicia tells us, “Julie also has a great sense of humor accompanied by a great laugh. It is fun watching TV with Julie because we appreciate her laugh so much.”

(continued on next page)

Aurora House *(continued)*

Program Director Crystal Jackson shares, “What I appreciate most about the HC and DSPs at Aurora is the fact that they are always there when someone is in crisis. If Alicia has an emergency, the staff jump in and make sure the schedule is covered, the house has all the supplies needed, and that the clients are not worried about having their daily routines interrupted. Alicia is great, she is always there when needed, helping her staff, and she calls me when the clients need extra support.”

If someone is scared to go to the doctor, we work together to calm them, reassuring them they will be fine. Alicia is a very quick learner, but knows when she needs help, and is not afraid to ask for assistance. The staff at Aurora House do a great job. It’s very nice to have a team that knows what they need to do and just jumps into action when the chips are down.”

A visit to Aurora House guarantees a warm welcome by clients and staff. The bond they have for one another is readily apparent, and they are very gracious hosts.

They truly are bright, shining Aurora Stars!



Anita, Alicia, Crystal and Lisa brainstorm a weekend adventure.

Action Central!

Our Plato Campus is a busy place.

Here are just a few images depicting some of the joy clients have been experienced in Glee Club, Theater Class, our “Exploring Self-Identity Through Dance” class, and our “Ladies Day In” events for our In-Home program clients. Our clients never cease to amaze us with their energy and creativity. We’re grateful to our donors, to the Janice Gardner Foundation, the Metropolitan Regional Arts Council, and to the Minnesota State Arts Board. Your gifts make these programs possible.



Jenny loves Theater, Dance and Glee Club.



Jack and Carolyn partnered up for Dance Class.



Peter has enjoyed Glee Club for a decade.



Anne has made many friends at Ladies Day In.

Volunteering – Our seasons wouldn't be as beautiful without our volunteers!

A few hours of volunteering at one of our houses brightens a whole season for the clients who call them home. Volunteer hours more than doubled this year, allowing so many more clients and staff at our group homes to enjoy a fresher Spring, a more colorful Summer, and a cozier Fall. We couldn't be more grateful to our many wonderful volunteers!

Our highest need is for Spring, Summer, and Fall yard beautification. Whether that be for planting flowers, trimming bushes, weeding the landscaping, laying mulch, painting a deck, or general cleanup, we are always looking for more volunteers to come and enjoy the fresh air and refreshments while making our clients' yards a thing of beauty. These projects are perfect for corporate teams, church and school groups, fraternities and sororities, and individuals who just need a change of pace from the usual routine and want to do some good. As always, Associated Bank championed our cause this year, sending multiple teams to paint, rake, and garden around our homes through their Roots in Our Community program. We also welcomed awesome new volunteer teams from Dairy Queen and LexisNexis Risk Solutions.

We love seeing volunteers express their artistic side by decorating gourd birdhouses for our gala silent auctions, so we were delighted to have more submissions than ever at our 50th anniversary Power of Love Gala– each one more stunning than the last! Among our artists were the amazing students of Minnetonka High School, who lent their talents to us for the third straight year, and we so appreciate the Two Rivers High School Key Club for sharing their creative visions with us for the first time!



Volunteers From Dairy Queen made work seem fun!



Associated Bank's volunteers help us every year. (above)
A trio of support from LexisNexis Risk Solutions (left)
Mahoney|CPAs and Advisors' volunteers "audited" landscaping needs at 29th Ave. (below)

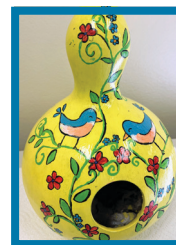

Rocking Robbins Gourd

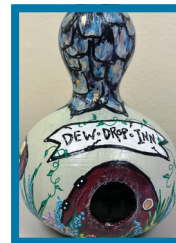

An Inviting Home

Thank you to all of our volunteers for your generous gifts of time. For more information about volunteer opportunities, contact Keller Karlstrom, Community Engagement Specialist, kkarlstrom@wingspanlife.org or call 701.205.6233.

Donors to Wingspan Life Resources

We thank our extended family of businesses, corporations, family members, foundations, staff, volunteers and other caring individuals for their gracious support that helps enrich the lives of people served by Wingspan.

The donor list below recognizes donors for their cumulative gifts received between July 1, 2022 and June 30, 2023.

If we have misspelled your name or have failed to include your name on the donor list, please accept our apologies and let us know of the error by calling the Development Office at 651.888.3112.

CORPORATE AND FOUNDATION SUPPORT

\$10,000 - \$25,000

Anonymous
Digital Mass, Inc.
Minnesota State Arts Board
Our House of Minnesota, Inc.
South Robert Street Business Association

\$5,000 - \$9,999

Associated Bank
Geritom Medical, Inc.
Minnesota Department of Human Services
HCBS Provider Capacity Grant Program

\$1,000 - \$4,999

Dual Citizen Brewery & Minneapolis/St. Paul Foundation
Edina Realty Foundation from:
Edina Realty Roseville
Edina Realty Title Office
Graystone Consulting/
Morgan Stanley
Great Southern Bank
LPL Financial
Standard Insurance Company
The Ashtabula Giving Fund
The Janice Gardener Foundation
UCare Minnesota
USI Insurance Services

\$500 - \$999

Cummings Mobility
Lotus Pharmacy
Fifth Generation, Inc.
Gerten's Greenhouses
Medica
Residential Heating and Air

\$499 & under

Ace Auto Parts
Adam's Pest Control
All American Auto
Amazon Smile Network
Cady Business Technology



Carson, Clelland & Schreder
Catholic Community Foundation
E-Z Recycling
Facebook
Dar's Double Scoop
Dawg's BBQ
General Mills
Greater Green Bay Community Foundation
Mahoney I CPAs and Advisors
Metro Sales, Inc.
Olsen Thielen CPAs
Polaris
Polish American Club
Pro Drywall & Painting, Inc.
Royal Star Liquidators
Seestedt's
Sensuous BBQ
TPC Landscape, Inc.
TSE, Inc.
UBS Matching Gifts Program
United Health Group
Walmart Spark for Good

INDIVIDUAL DONORS

*Staff **Board & Finance Committeeed

\$25,000 and above

Thomas & Anne Marie Peltier

\$10,000 and above

Anonymous
Anonymous

\$5,000 - \$9,999

Sandy Eickhoff
Nancy & Bill Jones
Angela** & Ryan O'Neill
John** & Jan Thames
Rosemary Townsend
Jeanne P. Tennesfos Grantor CLUT

\$1,000 - \$4,999

Bergie** & Darlene Bergerson
Nancy Broerman
Sandra Brownell
Maggie Brown & Paul Butt
Ann & Mike Cibulka
Virginia Connors
Bill & Betsy Cook
Ralph & Mary Pat Davini
Therese Davis*
Joe Eickhoff**
Gavin & Abby Forrette
Dan & Jeri Freier
The Friedman Family
Bill & Ginger Hamer
Michael & Shelly Hanson
Catherine Holtzclaw
Bruce & Debbie Homan
Marlene Hoppel
John Horberg
Ana & Pete King
Karen Kitchel & Larry Teckenbrock
Preston** & Jessica Koenig
Mark** & Jane Landreville
Rick & Gail Larson
Becky & Andy Lindstrom
Mark** & Tracy Mooney
Joanne & Brian Mullen
Donald & Nancy Nelson
Dale & Jeri Peterson
Paul & Jeanne Ravich
Nicholas & Peggy Rolfe
Ione & Roger Rolstad
Bob & Tracy Rossbach
Barb & Bruce Smith**
John & Erin Thames
Jeff & Wendy Thames
Claudia Wagner
Mike Weigel
Kim** & Tyler Wolff
Sylvia & Ambrose Zeller

\$500-\$999

Mary Anderson**
Anonymous
Ben Ayvaz
James & Linda Benson
Julie & John Brenny
Mike Burakowski
Keith & Carolyn Campbell
Deana & Zach Chase
Lino & Donna Cordoba
Marty & Jessica Davis
Bill & Michelle Gleason
Alex & Samantha Greene
Carolyn & Dave Hendrickson
Steven & Kathryn Karel
Sue & Kent Karlstrom
Mike & Patty Kirchner
Taree Leach-Junkersfeld**
& Mark Junkersfeld
James Lockhart & Janie Mayeron
Betsy McBride
Stephanie Mehta
Scott & Lori Meyer
Dan Mooney
Karen Nelson
Peggy Neurer
Karin Norsten
Bonnie Russ
John & Connie Schlundt
Helen Smith
Cathie Sorko-Ram
Mary Beth Stearns
Claire Steyaert
James & Jeanine Sundberg
Brian & Kristen Sundberg
Jenny Thames
John & Linda Traxler
Jennifer & Doug Ulrich
Jenna Untiedt
Donald & Julie Wagner
Thomas & Deborah Walker
David & Jessica Widdifield
Curt Windingstad
Maggie Yanez**

\$100-\$499

Christie & Terrie Amundson
Cloe & Ian Angelo
Emily & Mark Arend
Stanley & Robin Asbell
Michael Atton
Leasha Barnes
Diane & Brad Benyas
Dan & Lisa Bergerson
Dean & Colleen Bergerson
Laurel Bluhm & Steve Bluhm
Stacy Boehmer*
Jeff Hager* & Micheal Brannan
Peter Bridston
Donna Caldwell
Carolyn Campbell*
Pam Carlson*
Danielle Cherrill
Betty Cole
Anne Corgard

Jenny Cox
Catherine Curtis
Tim & Sarah Delforge
Donna DeMatteo
Justin & Leslie Donato
Susie Donohue
Judith Duncan
Kathleen Dunleavy
Kerry & Dr. Richad Ehrmanntraut
Jim Erickson
Laurence & Jane Eshleman
Fiona Eustathiades*
Louise & Charles Feske
James & Mary Fignar
Sharon Franz
William & Kathleen Freeman
Deborah Fulton
Elizabeth Gatti
Margaret George
Donna Gramstad
Darolyn Gray* & Carolee Lindsey
Gary & Catherine Gustner
Ben & Louise Hamer
Henry & Barbara Hanson
Carol Hanson*
Mary Heinz
Jerome Hertel & Toni DeRosier
Deb Hofbauer*
Ron Hoff
Rudy Hokanson & Susan Miller
Nancy & Mike Hopp
Virginia & Roger Huseby
Eugene* & Natasha Hyatte
Tim & Keeley Johnson
Susan Johnson
Kristi & Michael Kampmeyer
Pat & Melissa Kehoe
Daniel & Kelly Kivel



Robert & Michele Kleason
Karen & Chuck Kleinstaub
Duane & Barbara Kocik
Amy & Mark Kohout
Julianne & Paul Kollitz
Debbra Korkowski
Mary Kremers
William Kronschnabel
Marlene Krupich
Joshua & Emmy Lackner
Dr. JoAnn Laes
Mary Langley
Mike & Ali Langley
Juanita & David Lauritsen



Norm & Pat Linnell
Jean Lynch
Jill Lytwyn
Steven & Jane Martin
Lori Mason*
Brent Mattfield
Janice & John McCauley
Dennis & Kathryn McGuire
Mike & Anne McQuillan
Lynne & Kevin Megan
Frank* & Maureen Merrill*
Blake & Julia Meyer
Steve Michel & Mary Lou Michel
Robert Miller
Melissa & Josh Miller
Bridget Mollner
Deb Monk*
Patrick & Sue Mooney
Kira Mostad
John Nanninga
David & Linda Nash
Ronalee Neubauer
Jeanette & Roy Newman
Kevin Noel
Barb Novak
John & Cynthia O'Halloran
Eileen O'Shaughnessy
Molly O'Shaughnessy
& Michael Monahan
Rebecca Ouimet-Lewis
Valerie Paige
Linda Pearl & Nick Brill
Dorothy Petersen
Barbara Peterson
Bill & Mae Petrangelo
Charlotte Pfeiffer
Ann Pogatchnik
Nickolas & Judy Priadka
Kristin Procopio
Kyle Rabine
Richard & Kathleen Redfern
Scott & Tomilee Reinhardt
Susan Rettinger
Ann Roe
Joseph & Jen Rolfe
Kristin Rone
Joan Ryan
Renee & Greg Sagmoe
Lolly McNeely Salmen
Judy Schreifels
Lowell Schwab & Rae Carter
Daniel & Rita Sevenich

(continued on next page)

(Donors continued)

I-Ming Shih & Arnold Chu
Theresa Simpson
Steven Smith & Deborah Zvosec
Heidi Solomon
Stacy Stanslaski
Michael & Linda Strand
Wade & Janelle Strop
Judy & Frank Stucki
Robert & Marjorie Tausek
Chaley Thames
James & Marianne Tracy
Sherri & Fred Trapp
Donald & Dolores Traxler
Rick Trueman
Paul Urbanski
Ben Veach
Elaine Voboril & Marnie Milbert
Lou Vogel
Peggy & Dale Warfield
John & Sylvia Webb
Tami Weigel
Terra Widdifield & Mark Gitch
Carl Wild
Kathy Wolff
Jim & Rita Wood
Jim & Susan Zenner

\$99 and under

Mary Ann Adrian
Osasu Aduayi
Diane Ahlstrom
Kevin & Patti Albertson
David Allen
Birhane & Fente Ambaw
Mary Ammer
Anonymous
Sara Baldwin
Jim Bebeau



Ken Bence
John Berber
Joan & James Berglund
Joe Bjelland*
Julie Blomquist
Lori Breislee
Wade Brelje
Mary Burke
Troy Canfield
Leonard & Beatrice Capaul
James Cochran
Kathleen & Thomas Colaizy
Catherine Connett
EJ Cruickshank

D.J. Dahl
Arpita Dasgupta
Mary Delaney
Lydia Dougherty
Kathleen & Donald Doyle
Donald & Linda DuBois
Vickie & David Dzieweczynski
Fred Edstrom
Barb Edstrom
Doug Eisterhold
Jill Ettesvold
Ben Fairbanks
Mary Joan Faricy
Erin Fete
Deon Ford
Clarice Forrette
Sandy Foss
Josh Fowler
Breana Gerber
Tom Gillund
Jan Gonder
Linda Goneau
Elaine Grittner
Ken Grosinger
Kelleen Gutzmann
Patrick & Lauri Haid
Mary & Joseph Hamelin
Sara Hanson
Jo Ellen Hargis
Kathleen Hartmann
Deanna Hartshorn
Carol & Don Haslach
Kathy Heimer
Deborah Hendry
Doug Henry
Lisa Henry
Diane Hernon
Becky & Chuck Human
Kathy Isaacson
Eleaisha Jackson*
Amy Jansen
Kara & Ben Jennings-Boyd
Ted & Betsy Jessen
Karen Johnson
Kathleen Johnson
Nicole Jolly
Bonnie Jony
Constance Jurkovich
Paul Kamp
Keller Karlstrom*
Kenneth & Elizabeth Kauth
Deb Kelly
Blake Kelly
Timothy & Florence Kenney
Dan & Kelly Kivel
Nancy Klemz
Joel Knoepfler
Dustin Kroska
Lynn Lamers
Shirley Larson
Susan Larson
Dan Leach
Allen Lecuyer
Andy Lee



Eugene Lerach & Marge Lerach
Debbie Lewis
Bob Libke
Tim Lindgren
Peg Lonnquist & Celeste Culberth
Mary Jean Loomis
Paul Lubinski
Francis Madden
Jane & Thomas Maguire
Tony Mahmood
Joe Mahoney Tina Mahoney
Alex Maleki
Joelle & Michael Marchio
Mary Marcoux
Melissa Mazzara
Laurie McGrew
James & Janine McQuillan
Ellen Meier
Stacy Mersy
Carl Michaud
Mike & Sara Mountain
Roxanne Mullihan
Mary & Tim Murray
Kathy Neuman
Diane Nyberg
Mary O'Brien
Diane Olson
Rozella Orr
LaDonna Osborne
Kennard Pankonien
Bobbie Paske
Kim Phair & Dale Phair
Kathy Powers
Jim Probst
Steve & Shelly Putz
Charlie & Ardis Quick
Anita Regino
Janette Reinhardt
Jim Reiter
Frank Riley
Stacy Roe
Brenda Rohde
Martha Rossini Olson & Gary Olson
Brian & Pam Russ
Dan Salz
Betty & Paul Schaeppi
Andy Scharf
Anne & Paul Scheller
Scott Scheller
Tom Schreiber
Jake Schreiber
Dave Schreiber
Jeff & Jackie* Schultz
Anita Scott

Dale & Cindy Severson
Sidney Severson
Alice Shea
Nick & Annie Sirek
Clay Sollenberger
David Somers
Russell Spartz
Jane & Bob Staples
Claudia Stegora
Robert & Diane Stupka
Leslie Swenson
Lisa Thompson
Brian & Barbara Tisdle
Lou Vogel
Brad & Therese Walker
Eberhard & Tookie Werthmann
Bob Westlane
Valorie Whitmer
Camille Willner*
Ron & Linda Wizykoski
Brian Woo
Tony Zahradka

MONTHLY DONORS

Anonymous
Leasha Barnes
Jim Erickson
Bruce & Debbie Homan
Karen Nelson
Doug & Jennifer Ulrich

CORPORATE IN-KIND DONORS

A. Johnson & Sons
Afton House Inn
Alexis Bailly Vineyard
Alpha Phi Omega
Anytime Fitness Eagan Diffley
Aquarius Home Services
Associated Bank
Bacio
Bakken Museum
Baldinger Bakery
Bath and Body Works
Beth Gatti
Blue Plate Restaurant Company
Brad Fisher, Edina Realty
Buff City Soap Box
Can Can Wonderland
Chimborazo Restaurant
Chuck Carver Photography
Cities 97
Continental Diamond
Crystal Cave
Culver's of St. Anthony
Dairy Queen
D'Amico Catering
Dancing Dragonfly Winery
Doane University
DoubleTree by Hilton
Du Nord Social Spirits
Duluth Superior Symphony
Orchestra
Eagle Building Co

Imagine Entertainment
Fired Up Studios
French Meadow Bakery & Café
Fuzzy's Taco Shop
Gertens Greenhouses
Gifts for Seniors
Girl Scouts River Valleys
Give Hope MN
Glensheen Mansion
Grand Slam Family Fun Center
Great Lakes Aquarium
HandsOn Twin Cities
Hennepin Theater Trust
Illusion Theater
International Wolf Center
South Robert Street Business
Association
Joe's Sporting Goods
John's Crazy Socks
Kate's Bars
Laugh Camp Comedy Club
Leitner's Garden Center
Lettuce Entertain You Restaurants
Lift Bridge Lodge
Lilly Putt Inc. & Cheap Skate
Lions Tap
Lunderby Photography Inc.
MacPhail Center for Music
Mahoney CPAs
Mike Mooney Vikings Tickets
Minneapolis Gun Club
Minnesota Historical Society
Minnesota Horse and Hunt Club
Minnesota Landscape
Arboretum
Minnesota Lynx
Minnesota Orchestra
Minnesota State Fair
Minnesota Transportation Museum
Minnesota Vikings
Minnetonka High School
Mixed Blood Theatre
MN Dance Company
MN Renaissance Festival
Modist Brewing Co
MSHS Society
Murray's Steakhouse
National Mississippi River Museum
& Aquarium
New Hope Cinema Grill
New Scenic Café
North Shore Scenic Railroad
Paintball Minnesota
Park Tavern
Plaza TV
Pool & Yacht Club
Punch Pizza
Purpose Restaurants and Give Hope
R.F. Moeller Jeweler
Raising Cane's
Red's Savoy Pizza
Rick Bronson's House of Comedy
Running Aces
Saint Paul Chamber Orchestra
Sam's Club
Schuler Shoes

SeaQuest
Selective Insurance Company
Shepherd of the Valley Church
Shortstop Bar & Grill
Spectacle Shoppe
St. Croix Festival Theatre
St. Paul Saints
Stages Theatre Company
StageTime Productions
Standard Retirement Services
Suishin Restaurant
Sweet Martha's Cookies
Tangletown Gardens
Target Foundation
TC Running Company
The Burrow
The Cowles Center for
Performing Arts
The Museum of Russian Art
The Olive Grove
The Wellness Center
Theater Latte Da
Three Rivers Park District



Tito's Handmade Vodka
Top Ten Liquor
Topgolf
Total Wine & More
Trader Joe's
Treasure Island Resort & Casino
Triple Crown Indoor Batting
Two Rivers High School
Valleyfair
Viking Electric
Vitta Pizza
W2 Films
Wagner's Greenhouses
White Bear Meadery
Wild Mountain

FISCAL YEAR 2022-2023 INDIVIDUAL IN-KIND DONORS

*staff

**Board and Volunteers

Acosta, Dena**
Aken, Sharron*
Allyson, Roz**
Anderson, Mary**
Angelo, Cloe**
Angelo, Ian**

(continued on next page)

(Donors continued)

Asbell, Stanley*
Asbell, Robin
Aschbrenner, Eric**
Barnts, Jeremiah**
Bates, Will**
Bergerson, Bergie**
Bohl, Chris**
Brannan, Micheal**
Brock, Denise**
Broman, Sam**
Brown, Kiera**
Brown, Jacob**
Burchett, Audrey**
Campbell, Carolyn*
Cantin, Lita**
Carlson, Pam* & Chris Arne
Chalifonx, Jean**
Cloutier, Julia**
Combs, Hillary**
Davis, Therese*



DeGree, Jeff**
Dekkers, Joel**
Delforge, Tim**
DeReault, Madison**
Dodd, Susanne**
Dougherty, Devon
Drake, Sara**
Drake, Aaron**
Eagle Hawk, Lyle**
Eickhoff, Joe**
Ellis, Logan**
Engstrom, Nona**
Enninga, Heidi**
Faust, Tom**
Ferguson, Barb**
Ferrari, Ellen**
Fisher, Brad
Flintrop, Matt**
Foster, Danielle**
Fowler, Chloe**
Gannon, Patrick**
Gatti, Beth**
Gauger, Brett**
Gebhard, Aiden**
Geenen, Sam**
Gelder, Carter**
Georink, Polita**
Glidden, Ethan**
Grassmond, Kayleigh**
Gray, Darolyn* & Carolee Lindsey**
Gray, Molly**
Groen, Sara**

Grosvenor, Josh**
Gullickson, Cat**
Hansen, Stephanie
Harjovic, Adina**
Haviland, Pat**
Hessburg, Andy**
Arvidson-Hicks, Hans**
Hilbrand, Jared**
Hildesheim, Lindsey**
Hofmeyer, Karlee**
Hokanson, Rudy** & Susan Miller
Homan, Bruce**
Hoppel, Marlene
Hosseini, Soheil**
Hughes, Kylie**
Hunt, Chloe**
Jackson, Charles**
Jackson, Crystal*
Jansma, Tricia**
Janssen, Allie**
Jarvis, Kathy & Gordy
Jewell, Liv**
Johnson, Noah**
Johnson, Breanna**
Kadlec, Marlene**
Kalka, Joe**
Kalugdan, Serene**
Kalugdan, Naysa**
Kapaun, Lacey**
Kessler, Aaron**
Koenig, Preston**
Korkowski Family**
Kohout, Amy** & Mark**
Kotsonas, Marc**
Landreville, Mark**
LaRocca, Gianna**
Leach-Junkersfeld, Taree**
& Mark Junkersfeld
Lee, Jennifer**
Lemeuir, Sherri**
Lenartz, Joe**
Lindsey, Dixie**
Lindsey, Cathy**
Linhardt, Brandon**
Livermore, Hope**
Logan, Andrew**
Lotzer, John**
Lubbets, Griffin**
Lureen, Michelle**
Madsen, Aric**
Malecek, Ella**
Manion, Maria** & Matt**
Marchiniak, Jean**
Markle, Sophia**
Martinson, Leah**
Matara, Josh**
Matheny, Marilyn
Mayer, Chris**
McIvor, Gabe**
Mehsikomer, Mike**
Mendez, Marisa**
Merrill, Maureen**
Meygaard, Melat**
Meyer, Cierra**
Migiro, Edwin**
Miller, Adrianna**
Mobley, Adrienne**

Mooney, Mark** & Tracy
Mooney, Mike
Mullen, Brian & Joanne
Murray, Mary & Tim
Naysa**
Nelson, Hannah**
Nelson, Greg**
Nemecek, Grace**
Nordin, Lance**
Odell, Maggie**
Ohm, Jen**
Olijnek, Evan**
O'Neill, Angela** & Ryan
Oyinye, Ronke**
Petrangelo, Bill**
Pinney, Anne**
Popowitz, Gloria
Reinhardt, Steve**
Rocha, Aleah**
Roekrel, Cyla**
Rooy, Robert**
Ruff, Autumn**
Russ, Bonnie
Russell, Caroline**
Russell, Josh**
Sagmoe, Renee**
Sahu, Maya**
Salazar, Brayana**
Scheller, Scott**
Schmidt, Holly**
Serene**
Shimko, Marty**
Sisson, Kyla*
Slagh, Ellery**
Bruce, Bruce**
Smith, Judy**
Smith, Julie**
Spears, Noah**
Stanley, Bobbi**
Stearns, Mary Beth
Steinhaus, Alex**
Stevermer, Donna**
Stone, Sal**
Syrhe, Becky**
Tamerat, Faseka**
Taragel, Lubos**
Thames, Erin & John
Thames Jr, John** & Jan
Timm, Patrice**
Timmerman, Elise**
Tinholt, Jacob**
Torkelson, Mickie**
Ulman, Ashley**
Ulrich, Marissa**
Van, Caroline**
VanGolder, Jay**
Veach, Ben**
Vis, Cody**
Wagner, Kylie**
Walker, Cathy**
White, Walter**
Widdifield, Michael & Jen
Wolff, Kim** & Tyler
Yanez, Margaret**
Yusufeli, Shabbir**

IN HONOR OF

Mary Anderson by
Anonymous
Michael Atton
Joanne & Brian Mullen
Stacy Stanslaski
John Bernie by
Marlene Krupich
Jane Christenson by
Emily & Mark Arend
Julie & John Brenny
Marlene Hoppel
Shirley Larson
Ione & Roger Rolstad
Brian Connors by
Virginia Connors
Mary Pat Davini by
Anita Scott
Therese Davis by
Anonymous
Donna DeMatteo
Jeanette Newman
Paula DeSota by
Anonymous
Rachel Dunleavy by
James & Catherine Cochran
Kathleen Dunleavy
Barb Edstrom
Susan & Wallace Knight
Bobbie & Tim Paske
Jenny & Julie Eickhoff by
Anonymous
Joe Eickhoff
Sandy Eickhoff
David & Juanita Lauritsen
Mary Kremers
Don & Nancy Nelson
Pam Stoks
Sylvia & Ambrose Zeller
Sue Feske by
Louise Feske
Andrea Forrette
Gavin & Abby Forrette
Clarice Forrette
Karen & Chuck Kleinstaubert
Paul Urbanski
Judy Friedman by
The Friedman Family
Marcia & Steve Friedman
Darolyn Gray by
Cloe & Ian Angelo
Sarah & Max Baldwin
Amy & Mark Kohout
Carolee Lindsey
Claire Steyaert



Casey Gustner by
Cathy & Gary Gustner
Jeff Hager by
Micheal Brannan
Gail Hamer by
Bill & Ginger Hamer
Pat Haviland by
Barb & James Peterson
Paul Horberg by
John Horberg
Keller Karlstrom by
Sue & Kent Karlstrom
Anita Larson by
Rick & Gail Larson
John Leach by
Taree Leach-Junkersfeld
& Mark Junkersfeld
Ann Mahoney by
Mary Mahoney
& Kennard Pankonien
Jane & Bob Staples
Mary Meyers by
Peg Neurer
Dot Michlitsch by
Ronald & Linda Wzykoski
Mooney Family by
Rick Trueman
Dana Nygaard by
Laurel Bluhm
Patricia O'Connor by
Donna Caldwell
Chris Powers by
Kathy Powers
Tom Reinhardt by
Janette Reinhardt
Scott & Tomilee Reinhardt
Lori Reinike by
Terra Widdifield
Scott Scheller by
Paul & Anne Scheller
Jackie Schultz by
Birhane Ambaw
Dave Schreiber
Jake Schreiber
Tom Schreiber
Jeff Schultz
Zenner Family
Carolyn Siegel by
Anonymous
Mike Smith by
Barb & Bruce Smith
Helen & Bruce Smith
Lori Stucki by
Anonymous
Marilu Bamberry
Peter Teneffos by
Jeanne P Teneffos Grantor Trust
John Nanninga
David & Jessica Widdifield
Kathy Thames by
Terri & Christie Amundson
James & Linda Benson
Mary Faricy
Thomas & Anne Marie Peltier
Nick & Peggy Rolfe
James & Jeanine Sundberg
Jeff & Wendy Thames



Jenny Thames
John & Erin Thames
John & Jan Thames Jr.
Claudia Wagner
Kim & Tyler Wolff
Linda Thomsen by
Bruce & Debbie Homan
Wally Ulmanec by
Sara Hanson
Pam Walker by
Brad Walker
Tina Windingstad by
Curt Windingstad
Debra Wise by
Rozella Orr
Kim & Tyler Wolff
Erin Fete

IN MEMORY OF

Michele Alvord by
Pam Carlson
Sharon Franz
Patrick & Lauri Haid
Diane Hernon
Kathleen Johnson
Susan & Wayne Johnson
Frank & Maureen Merrill
Rexanne Mullihan
Diane Nyberg
Diane Olson & Michael Schneerer
Kimberly Phair
Leslie Swenson
Donald Wagner
Lynn Bergerson by
Dan & Lisa Bergerson
Dean & Colleen Bergerson
Bergie & Darlene Bergerson
Nancy Hopp
Scott & Lori Meyer
Paul & Jeanne Ravich
UBS Matching Gifts
Harold Burke by
Mary Burke
Meredith Claire
Mary Beth Stearns
Carol Cox by
Pat Castellano
Ruth DeRosan by
Jerome Hertel
Liz Duffy by
Ann & Mike Cibulka
Tom Green by
Anonymous

Bob James by
Anonymous
Patricia Karr by
Anonymous
Carol Reiger
Dave Katz by
Sandy Eickhoff
Corrine & Ray Knickerbocker by
Carolyn & Dave Hendrickson
Bev & Kathy Mooney by
Susan Larson
Melissa & Josh Miller
Dan Mooney
Mark & Tracy Mooney
Peggy & Dale Warfield
Kathy Mooney by
Steve Smith & Deborah Zvosec



Betty Nordin by
Lino & Donna Cordoba
Joel Olaniyi by
Anonymous
Bergie & Darlene Bergerson
Renee Ophoven
Mary Rasmussen by
Larry & Jane Eshleman
Ruth Rose by
Claudia Wagner
Ronald Snyder by
Donna James
Ron Stearns by
Mary Beth Stearns
Jane Steichen by
Mary Beth Stearns
John Steyaert by
Claire Steyaert

Jane Thames by
Anonymous
Mary Adrian
Christie & Terri Amundson
Joan & James Berglund
Nancy Broerman
Keith & Carolyn Campbell
Kathleen & Thomas Colaizi
Catherine Connett
Catherine Curtis
Mary Delaney
Donald DuBois
Vickie & David Dziewieczynski
Kerry & Rick Ehrmanntraut
Mary Faricy
William & Kathleen Freeman
Margaret George
Mary Nadine Hamelin
Kathleen Hartmann
Jerome Hertel
Theodore & Elizabeth Jessen
Timothy & Keely Johnson
Kristi & Michael Kampmeyer
Kathryn & Stephen Karel
Kenneth Kauth
Timothy & Florence Kenney
Bob & Michele Kleason
Paul & Julianne Kollitz
William Kronschnabel
Emily & Josh Lackner
Eugene & Marjorie Lerach
Mary Jean Loomis
Jean Lynch
Jane Maguire
Joelle Marchio
Steven & Jane Martin
Betsy McBride
Janice McCauley
Kathy McGuire
Lolly Salmen McNeely
James & Janine McQuillan
Mike & Anne McQuillan
Stephen & Mary Michel
Robert Miller
Michael & Sara Mountain
Mary O'Brien



John & Cynthia O'Halloran
Eileen O'Shaughnessy
Molly O'Shaughnessy
Thomas & Anne Marie Peltier
Dick & Kathy Redfern
Joseph & Jennifer Rolfes
Nick & Peggy Rolfes
Kristin Rone
Martha Rossini
Betty & Teresa Schaeppi
Nick & Ann Sirek
Robert & Diane Stupka
James & Jeanine Sundberg
Jeff & Wendy Thames
Jenny Thames
John & Jan Thames
John & Erin Thames
Donald & Dolores Traxler
John & Linda Traxler
Claudia Wagner
Kathleen Werthmann
Kim & Tyler Wolff
Andy Wiemeier by
Donna DeMatteo
Darrell, Sue, & Andy
Wiemeier by
Darolyn Gray & Carolee
Lindsey
Carolyn & Dave Hendrickson
Marge Winterer by
Claudia Wagner

Financial Summary

STATEMENTS OF ACTIVITIES

12 Months Ending June 30, 2023 and 2022

	2023	2022
Revenues (State of Minnesota, Hennepin, Ramsey & Dakota Counties)		
Residential	\$	\$10,456,066
In-Home	\$	\$ 723,853
Crisis Respite	\$	\$ 1,198,490
Contributions & Grants	\$	\$ 300,877
Other	\$	\$ 72,517
TOTAL	\$	\$12,751,803
Expenses		
Residential	\$	\$11,277,348
In-Home	\$	\$ 754,385
Crisis Respite	\$	\$ 1,164,043
Fundraising Expense	\$	\$ 254,055
TOTAL	\$	\$13,449,831
Income from Operations.....	\$	\$ (698,028)
Unrealized Gain or (Loss) on Investment	\$	\$ (483,127)
Other Interest Income.....	\$	\$ 199
Employee Retention Credits	\$	\$ 22,071
Gain or (Loss) on Disposal of Assets	\$	\$ 12,714
CHANGE IN NET ASSETS	\$	\$ (1,146,171)
Program Expenses	\$	\$11,998,167
Management & General Expenses.....	\$	\$ 1,197,609
Fundraising	\$	\$ 254,055
TOTAL	\$	\$13,449,831

STATEMENTS OF FINANCIAL POSITION

June 30, 2023 and 2022

	2023	2022
Assets		
Current Assets	\$	\$ 3,788,948
Investments	\$	\$ 4,206,805
Property & Equipment, Net	\$	\$ 5,935,935
Other Assets	\$	\$ 56,268
TOTAL ASSETS.....	\$	\$13,987,956
Liabilities and Net Assets		
Current Liabilities	\$	\$ 1,522,059
Long Term Debt	\$	\$ 425,561
Long Term Other	\$	\$ 56,268
Net Assets	\$	\$ 11,984,068
TOTAL LIABILITIES & NET ASSETS.....	\$	\$13,987,956

Thank You
for making Wingspan Life Resources
your charity of choice!

Donate 24/7 at: www.wingspanlife.org

United Way & Community Shares Campaigns:
Please designate Wingspan Life Resources as your Donor Choice



Thank you to Chuck Carver of Carver Photo for some of the images in this report.